

COSMOPOLITAN COLLECTION



WALTZ

REF: CM3032

DESCRIPTION

Influenced by the metallic rods used in the mechanical parts of the industrial revolution, we find Waltz a strong, safe, highly resilient piece that perfectly fulfils its function.

A drawer handles that, due to its extreme simplicity, is practically absorbed by the drawer where it is to be placed, but always assigning the value to his function.

MATERIAL

Brass

FINISHES

Polished Brass & Black lacquer (Also available in Aged & Brushed Brass)

DIMENSIONS

Height: 200 mm | 8,66 in

Length: 12 mm | 0,47 in

Depth: 38 mm | 1,49 in

WEIGHT

183 g / 0,40 Lbs

FIXING SYSTEM

M5 Screws

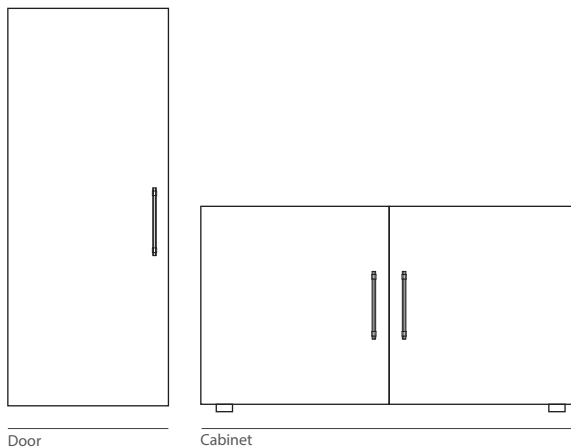

Door

Cabinet

